

CASTING BRONZE FLANGED BUSH

SOBF

● Sliding Direction

● Mating post tolerance
 d8: General use (high load)
 e7: General use (light load)
 f7: High precision

● Other operating conditions and characteristics
 · Can be used in the atmosphere and fresh water (on condition).
 · Good performance in operation under high load and at low speed.

⚠ When the product is used at high temperature (150°C or more), the embedding specification of solid lubricant is different. Please contact us for details.

Material
 Base Bronze 500SP
 Graphite lubricant (SL2)

■ Operation Range

Lubricant Type	Lubricating Condition	Environment Condition	Max. Allowable Load P N/mm ²	Max. Allowable Sliding Speed V m/min	Max. Allowable PV value N/mm ² · m/min	Operation Range Temperature °C
SL2	No Lubrication	Atmosphere	100	15	150	-50 ~ +300
	Regular lubrication (Grease)			30	200	-50 ~ +150

■ Physical Properties

Specific Gravity g/cm ³	Hardness HB	Elongation %	Tensile Strength N/mm ²	Linear Expansion Coefficient ×10 ⁻⁵ /°C
7.9	210 or more	12 or more	755 or more	1.9

Order **Model No.** **d** - **D** - **L**
SOBF 18 - 24 - 30

d E7	D r6	D ₁	t	Ra	g	Tolerance d after press-fit	Model No.	d	D	L
8	12	20	0.5	1	1	+0.025 +0.009	SOBF	8	12	10
								15		
10	14	22	2	1	1	+0.022 +0.006	SOBF	10	14	10
								15		
								17		
12	18	25	1	1	1	+0.035 +0.016	SOBF	12	18	15
								20		
								25		
13	19	26	1	1	2	+0.031 +0.012	SOBF	13	19	15
								20		
14	20	27	3	1	1	+0.031 +0.012	SOBF	14	20	15
								20		
								25		
15	21	28	3	1	1	+0.028 +0.009	SOBF	15	21	15
								20		
								25		
16	22	29	3	1	1	+0.028 +0.009	SOBF	16	22	15
								18		
								20		

d E7	D r6	D ₁	t	Ra	g	Tolerance d after press-fit	Model No.	d	D	L
16	22	29	3	1	1	+0.028 +0.009	SOBF	16	22	23
								30		
								35		
								40		
18	24	32	3	1	1	+0.041 +0.028	SOBF	18	24	20
								30		
								30		
20	30	40	2	1	1	+0.042 +0.020	SOBF	20	30	15
								20		
								25		
								30		
25	35	45	2	1	1	+0.034 +0.012	SOBF	25	35	20
								25		
								30		
								35		
30	40	50	2	1	2	+0.048 +0.022	SOBF	30	40	25
								30		
								35		
								40		
35	45	60	5	1	1	+0.048 +0.022	SOBF	35	45	30
								35		
								40		
								40		
40	50	65	2	1	1	+0.045 +0.019	SOBF	40	50	30
								40		
								40		
								40		
45	55	70	2	1	1	+0.045 +0.019	SOBF	45	55	30
								45		
								45		
								45		
50	60	75	2	1	1	+0.038 +0.012	SOBF	50	60	30
								50		
								50		
								50		
55	65	80	2	1	2	+0.053 +0.022	SOBF	55	65	40
								55		
								55		
								60		

CASTING BRONZE FLANGED BUSH

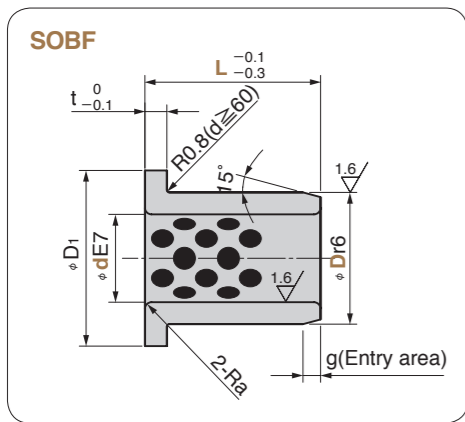

Order **Model No.** **d** - **D** - **L**
SOBF 90 - 110 - 60

d	E7	D	r6	D ₁	t	Ra	g	Tolerance d after press-fit	Model No.	d	D	L
60		75	+0.062 +0.043	90				+0.052 +0.021	SOBF	60	75	40
					7.5					50		
										80		
70	+0.090 +0.060	85		105						70	85	50
										80		
80		100	+0.073 +0.051	120		3	3	+0.045 +0.014		80	100	80
										100		
90		110		130	10					90	110	60
										80		
100	+0.107 +0.072	120	+0.076 +0.054	150				+0.059 +0.023		100	120	80
										100		
120		140	+0.088 +0.063	170				+0.051 +0.015		120	140	80
									100			

Operation Range (SO#50SP2)

Lubricant Type	Lubricating Condition	Environment Condition	Max. Allowable Load P N/mm ²	Max. Allowable Sliding Speed V m/min	Max. Allowable PV value N/mm ² ·m/min	Operation Range Temperature °C
SL2	No lubrication	Atmosphere	100	15	150	-50~+300
	Regular lubrication(Grease)			30	200	-50~+150

Physical Properties (SO#50SP2)

Specific Gravity g/cm ³	Hardness HB	Elongation %	Tensile Strength N/mm ²	Linear Expansion Coefficient ×10 ⁻⁵ /°C
7.9	210 or more	12 or more	755 or more	1.9

SOBFU

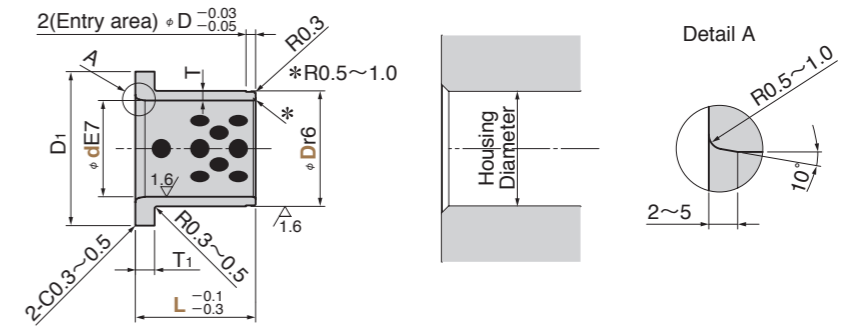

● Sliding Direction



Mating post tolerance

- d8: General use (high load)
- e7: General use (light load)
- f7: High precision

⚠ Operation temperature is 150°C or less

Other operating conditions and characteristics

- Can be used in the atmosphere and fresh water (on condition).
- Good performance in operation under high load and at low speed.

Material
 Base Bronze 500SP
 Graphite lubricant (SL2)

d	E7	D	r6	D ₁	T	T ₁	Tolerance d after press-fit	Model No.	d	D	L
5		7		11				SOBFU	5	7	10
							+0.017 +0.005		12		
6	+0.032 +0.020	8		12					6	8	12
			+0.028 +0.019						15		
									10		
8		10		14	1	2	+0.023 +0.008		8	10	12
									15		
									20		
									10		
10	+0.040 +0.025	12		16			+0.020 +0.004		10	12	12
									15		
									20		
								10			
12		15		21				12	15	15	
								20			
			+0.034 +0.023					25			
								30			
13		16		22	1.5		+0.030 +0.011	13	16	12	
								15			
								20			
								10			
15	+0.050 +0.032	18		24		3		15	18	15	
								20			
								25			
								12			
16		20		26			+0.025 +0.006	16	20	15	
								20			
								25			
								30			
								15			
20		24	+0.041 +0.028	32	2			20	24	20	
								25			
								30			
								40			
25	+0.061 +0.040	29		37		4	+0.036 +0.014	25	29	30	
								40			
								50			
30		34	+0.050 +0.034	42			+0.031 +0.009	30	34	30	
								40			
								50			

Order **Model No.** **d** - **D** - **L**
SOBFU 20 - 24 - 30